

Parallel gripper Three-jaw gripper **Angle gripper** Internal-hole gripper Other grippers Electric gripper

GK15N GK20N GK25N GK35N **GK40N** GK50N Bumper blocks



- Sommer-automatic
- Grippers**
- Separators
- Swivel units
- Rotating jaws
- Axial compensators
- Tool changers
- Linear cylinders
- Shock absorbers
- Rotary cylinders
- Air vane motors
- Vacuum components
- Accessories
- Quick finder

Flow control valves are recommended (especially when using longer fingers) in order to reduce the shock to jaw

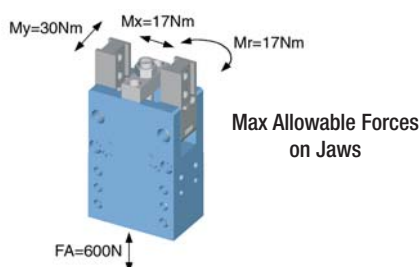

## Pivoting arm gripper

Advantages, benefits, comparisons and tips! Stacks of information all about this product are on page 147.

Gripping force as a function of opening angle

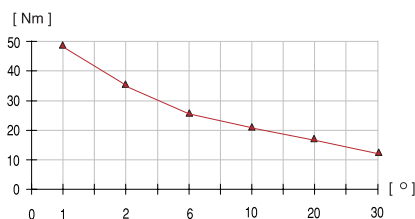

Gripping force as a function of jaw length (measured at 1° opening angle)

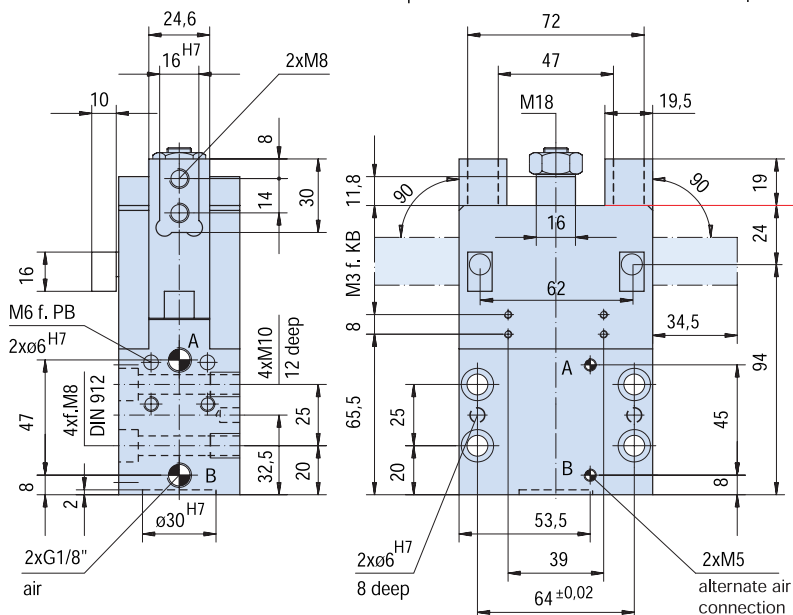
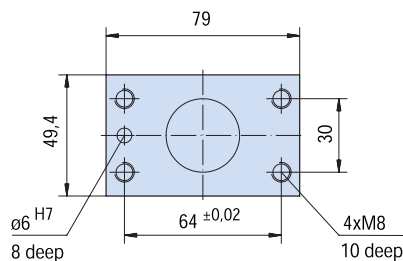
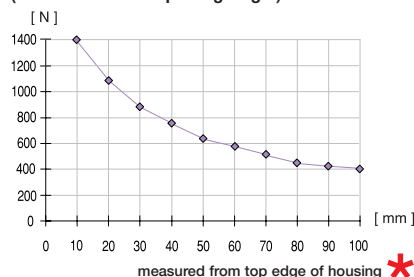

<b>Order no.:</b>			
<b>GK40</b>			
<b>N</b>			
<b>Drive:</b>			
pneum.			
<b>Stroke per jaw [°]:</b>			
90			
<b>Gripping force in closing [N]**:</b>			
1400			
<b>Gripping torque in closing [Nm]:</b>			
48			
<b>Self-locking via:</b>			
mech.			
<b>Closing time/opening time [s]:</b>			
0,4			
<b>Repeatability ± [mm]:</b>			
0,1			
<b>Min./max. operating pressure [bar]:</b>			
4/10			
<b>Air volume per cycle [cm³]:</b>			
78			
<b>Min./max. operating temperature. [°C]:</b>			
5/80			
<b>Temp. resistant version up to 150°C [add to part number]:</b>			
T2			
<b>Piston diameter [mm]:</b>			
40			
<b>Weight [kg]:</b>			
1,67			

All data measured at 6 bar.

See Page 147 for Accessory list.

\*\* Measured at 10 mm from top edge of housing. \*