

Parallel Gripper

**Three-jaw gripper**

Angle gripper

Internal-hole gripper

Other grippers

Electric Gripper

GD29



- Sommer-automatic
- Grippers**
- Separators
- Swivel units
- Rotating jaws
- Axial compensators
- Tool changers
- Linear cylinders
- Shock absorbers
- Rotary cylinders
- Air vane motors
- Vacuum components
- Accessories
- Quick finder

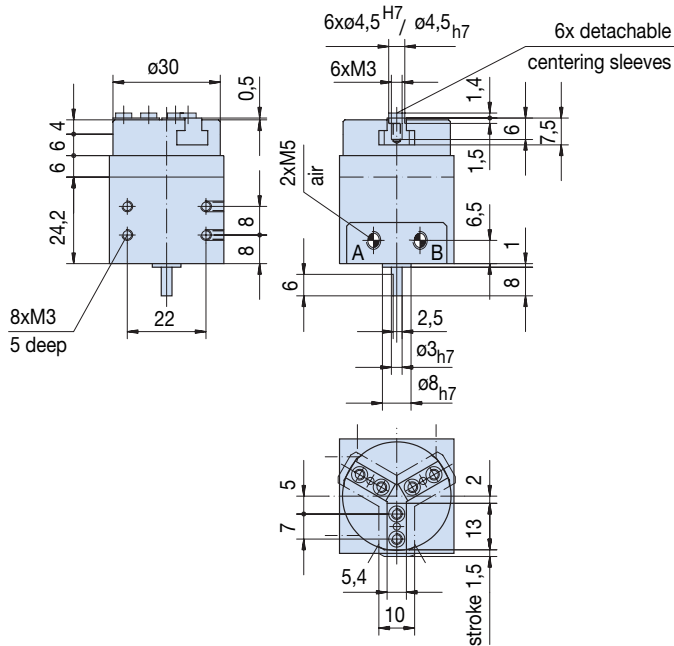
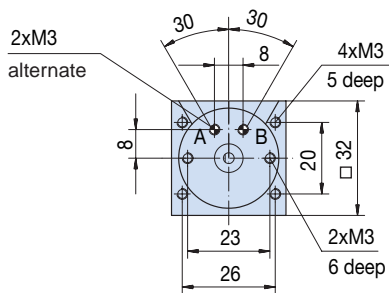
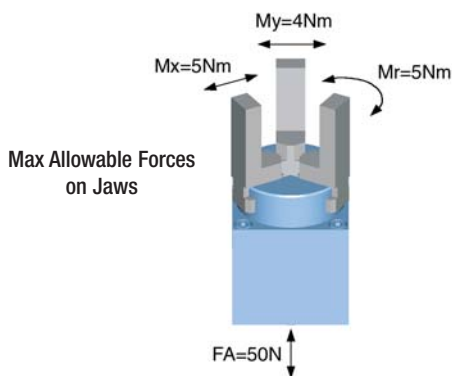

## Three-jaw gripper with cam drive and T-slot guide

Advantages, benefits, comparisons and tips! Stacks of information all about this product are on page 139.

Order no.:	GD29			
Drive:	pneum.			
Stroke per jaw [mm]:	1,5			
Gripping force in closing and opening [N]:	45			
Self-locking via:	DSV1/8			
Closing time/opening time [s]:	0,03			
Repeatability ± [mm]:	0,02			
Min./max. operating pressure [bar]:	4/8			
Air volume per cycle [cm³]:	2			
Min./max. operating temperature. [°C]:	5/60			
Weight [kg]:	0,1			

All data measured at 6 bar.

See Page 139 for Accessory list.

### Position sensing:

- Order no. DB1**  
Rotation limiter
- Order no. NJ3-E2/02**  
Stop with integrated inductive proximity switch

