

Parallel gripper		Three-jaw gripper			Angle gripper	Internal-hole gripper	Other grippers	Electric gripper
GD304	GD306	GD308	GD310	GD312	GD316	GD320	Pressing star	Universal jaw



Pressing star for GD3-- series

Use the spring-loaded Pressing star to positively place your workpiece after the gripper jaws have been released. Perfect for loading lathes.



Sommer-automatic
Grippers
Separators
Swivel units
Rotating jaws
Axial compensators
Tool changers
Linear cylinders
Shock absorbers
Rotary cylinders
Air vane motors
Vacuum components
Accessories
Quick finder

Order no.:													
ADS306 C/O	ADS306 N/S	ADS308 C/O	ADS308 H	ADS308 N/S	ADS310 C/O	ADS310 H	ADS310 N/S	ADS312 C/O	ADS312 H	ADS312 N/S	ADS316 C/O	ADS316 H	ADS316 N/S
Spring force min./max. [N]:													
40/60	40/60	40/60	40/60	40/60	60/120	60/120	0/120	60/120	60/120	60/120	85/165	85/165	85/165
Max. pressure stroke [mm]:													
5	5	4	4	4	5	5	5	6	6	6	8	8	8
To match:													
GD306...C	GD306...N	GD308...C	GD308NH	GD308...N	GD310...C	GD310NH	GD310...N	GD312...C	GD312NH	GD312...N	GD316...C	GD316NH	GD316...N
GD306...O	GD306...S	GD308...O		GD308...S	GD310...O		GD310...S	GD312...O		GD312...S	GD316...O		GD316...S

Pressing star for GD304 and GD320 by request.

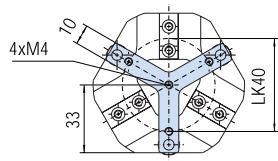
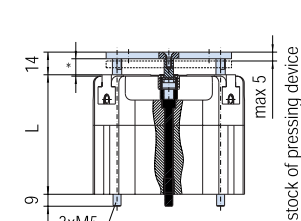

ADS 306 N/S L=43
 ADS 306 C/O L=60,5
 * height of jaw recommended = 11

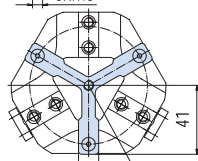
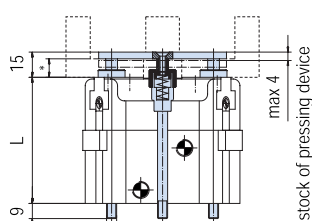

ADS 308 N/S L=50
 ADS 308 C/O L=75
 ADS 308 H L=54
 * height of jaw recommended = 11

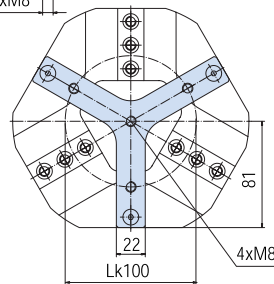
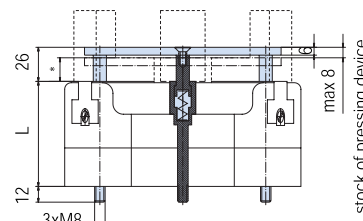

ADS 316 N/S L=80
 ADS 316C/O L=128
 ADS 316H L=85
 * height of jaw recommended = 18

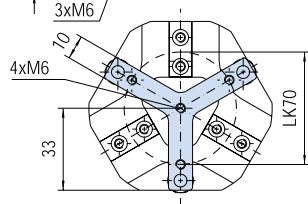
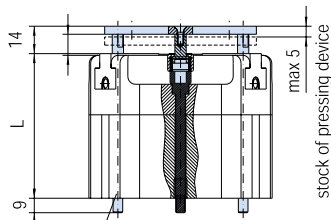

ADS 310 N/S L=59
 ADS 310 C/O L=89
 ADS 310 H L=63
 * height of jaw recommended = 13

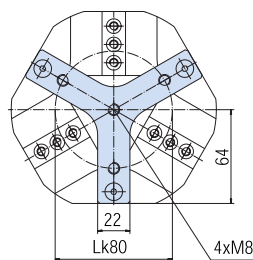
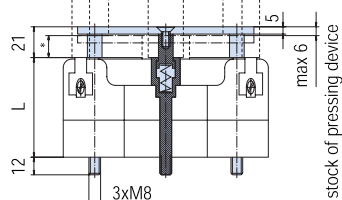

ADS 312 N/S L=68
 ADS 312 C/O L=105
 ADS 312 H L=73
 * height of jaw recommended = 15

Hand in hand!
 The gripper lets go. The pressing star pushes the workpiece into position.

